

DISCLOSURE STATEMENT: SELLER'S DISCLOSURE ALTERNATIVES

This form approved by the Minnesota Association of REALTORS®, which disclaims any liability arising out of use or misuse of this form. © 2016 Minnesota Association of REALTORS®, Edina, MN

- 1. Date 05/17/2018
2. Page 1 of pages: RECORDS AND
3. REPORTS, IF ANY, ARE ATTACHED AND MADE A
4. PART OF THIS DISCLOSURE

5. Property located at 800 N Arm Dr
6. City of Mound, County of Hennepin, State of Minnesota.

7. NOTICE: Sellers of residential property, with limited exceptions, are obligated to satisfy the requirements of MN Statutes
8. 513.52 through 513.60. To comply with the statute, Seller must provide either a written disclosure to the
9. prospective Buyer (see Disclosure Statement: Seller's Property Disclosure Statement) or satisfy one of the
10. following two options. Disclosures made here, if any, are not a warranty or guarantee of any kind by Seller or
11. licensee(s) representing or assisting any party in this transaction and are not a substitute for any inspections or
12. warranties the party(ies) may wish to obtain.

13. (Select one option only.)

14. 1) [] QUALIFIED THIRD-PARTY INSPECTION: Seller shall provide to prospective Buyer a written report that
15. discloses material information relating to the real property that has been prepared by a qualified third party.
16. "Qualified third party" means a federal, state, or local governmental agency, or any person whom Seller or
17. prospective Buyer reasonably believes has the expertise necessary to meet the industry standards of practice
18. for the type of inspection or investigation that has been conducted by the third party in order to prepare the
19. written report.

20. Seller shall disclose to prospective Buyer material facts known by Seller that contradict any information
21. that is included in a written report, or material facts known by Seller that are not included in the
22. report.

23. The inspection report was prepared by
24.
25. and dated, 20.

26. Seller discloses to Buyer the following material facts known by Seller that contradict any information included
27. in the above referenced inspection report.

28.
29.
30.

31. Seller discloses to Buyer the following material facts known by Seller that are not included in the above
32. referenced inspection report.

33.
34.
35.

36. 2) [X] WAIVER: The written disclosure required may be waived if Seller and prospective Buyer agree in writing. Seller
37. and Buyer hereby waive the written disclosure required under MN Statutes 513.52 through 513.60.

38. NOTE: If both Seller and prospective Buyer agree, in writing, to waive the written disclosure required under
39. MN Statutes 513.52 through 513.60, Seller is not obligated to disclose ANY material facts of which Seller
40. is aware that could adversely and significantly affect the Buyer's use or enjoyment of the property or any
41. intended use of the property, other than those disclosure requirements created by any other law. Seller is
42. not obligated to update Buyer on any changes made to material facts of which Seller is aware that could
43. adversely and significantly affect the Buyer's use or enjoyment of the property or any intended use of the
44. property that occur, other than those disclosure requirements created by any other law.

45. Waiver of the disclosure required under MN Statutes 513.52 through 513.60 does not waive, limit, or
46. abridge any obligation for Seller disclosure created by any other law.

48. Property located at 800 N Arm Dr Mound MN 55364

49. OTHER REQUIRED DISCLOSURES:

50. NOTE: In addition to electing one of the above alternatives to the material fact disclosure, Minnesota law also
51. requires sellers to provide other disclosures to prospective buyers, such as those disclosures listed below.
52. Additionally, there may be other required disclosures by federal, state, local, or other governmental entities
53. that are not listed below.

54. A. SUBSURFACE SEWAGE TREATMENT SYSTEM DISCLOSURE: (A subsurface sewage treatment system
55. disclosure is required by MN Statute 115.55.) (Check appropriate box.)

56. Seller certifies that Seller [] DOES [X] DOES NOT know of a subsurface sewage treatment system on or serving
57. the above-described real property. (If answer is DOES, and the system does not require a state permit, see
58. Disclosure Statement: Subsurface Sewage Treatment System.)
59. [] There is a subsurface sewage treatment system on or serving the above-described real property.
60. (See Disclosure Statement: Subsurface Sewage Treatment System.)
61. [] There is an abandoned subsurface sewage treatment system on the above-described real property.
62. (See Disclosure Statement: Subsurface Sewage Treatment System.)

63. B. PRIVATE WELL DISCLOSURE: (A well disclosure and Certificate are required by MN Statute 103I.235.)
64. (Check appropriate box.)

65. [] Seller certifies that Seller does not know of any wells on the above-described real property.
66. [X] Seller certifies there are one or more wells located on the above-described real property.
67. (See Disclosure Statement: Well.)
68. Are there any wells serving the above-described property that are not located on the property? [] Yes [X] No
69. To your knowledge, is the property in a Special Well Construction Area? [] Yes [X] No

70. Comments:
71. _____

72. C. VALUATION EXCLUSION DISCLOSURE: (Required by MN Statute 273.11, Subd. 18)

73. There [] IS [X] IS NOT an exclusion from market value for home improvements on this property. Any valuation
74. exclusion shall terminate upon sale of the property, and the property's estimated market value for property tax purposes
75. shall increase. If a valuation exclusion exists, Buyers are encouraged to look into the resulting tax
76. consequences.

77. Additional comments:
78. _____

79. D. FOREIGN INVESTMENT IN REAL PROPERTY TAX ACT ("FIRPTA"): Section 1445 of the Internal Revenue Code
80. provides that a transferee ("Buyer") of a United States real property interest must be notified in writing and must
81. withhold tax if the transferor ("Seller") is a foreign person and no exceptions from FIRPTA withholding apply.

82. Seller represents that Seller [] IS [X] IS NOT a foreign person (i.e., a non-resident alien individual, foreign corporation,
83. foreign partnership, foreign trust, or foreign estate) for purposes of income taxation. This representation shall
84. survive the closing of any transaction involving the property described here.

85. NOTE: If the above answer is "IS," Buyer may be subject to income tax withholding in connection with the
86. transaction (unless the transaction is covered by an applicable exception to FIRPTA withholding). In
87. non-exempt transactions, Buyer may be liable for the tax if Buyer fails to withhold.
88. If the above answer is "IS NOT," Buyer may wish to obtain specific documentation from Seller ensuring
89. Buyer is exempt from the withholding requirements as prescribed under Section 1445 of the Internal
90. Revenue Code.

91. Due to the complexity and potential risks of failing to comply with FIRPTA, including Buyer's responsibility
92. for withholding the applicable tax, Buyer and Seller should seek appropriate legal and tax advice regarding
93. FIRPTA compliance, as the respective licensees representing or assisting either party will be unable to
94. assure either party whether the transaction is exempt from the FIRPTA withholding requirements.

96. Property located at 800 N Azm Dr Mound MN 55364

97. **E. METHAMPHETAMINE PRODUCTION DISCLOSURE:**

98. (A methamphetamine production disclosure is required by MN Statute 152.0275, Subd. 2 (m).)

99. Seller is not aware of any methamphetamine production that has occurred on the property.

100. Seller is aware that methamphetamine production has occurred on the property.

101. (See Disclosure Statement: Methamphetamine Production.)

102. **F. RADON DISCLOSURE:**

103. (The following Seller disclosure satisfies MN Statute 144.496.)

104. **RADON WARNING STATEMENT:** The Minnesota Department of Health strongly recommends that ALL
105. homebuyers have an indoor radon test performed prior to purchase or taking occupancy, and recommends having
106. the radon levels mitigated if elevated radon concentrations are found. Elevated radon concentrations can easily
107. be reduced by a qualified, certified, or licensed, if applicable, radon mitigator.

108. Every buyer of any interest in residential real property is notified that the property may present exposure to
109. dangerous levels of indoor radon gas that may place occupants at risk of developing radon-induced lung cancer.
110. Radon, a Class A human carcinogen, is the leading cause of lung cancer in nonsmokers and the second leading
111. cause overall. The seller of any interest in residential real property is required to provide the buyer with any
112. information on radon test results of the dwelling.

113. **RADON IN REAL ESTATE:** By signing this Statement, Buyer hereby acknowledges receipt of the Minnesota
114. Department of Health's publication entitled **Radon in Real Estate Transactions**, which is attached hereto and
115. can be found at www.health.state.mn.us/divs/eh/indoorair/radon/rnrealestateweb.pdf.

116. A seller who fails to disclose the information required under MN Statute 144.496, and is aware of material facts
117. pertaining to radon concentrations in the property, is liable to the Buyer. A buyer who is injured by a violation of MN
118. Statute 144.496 may bring a civil action and recover damages and receive other equitable relief as determined by
119. the court. Any such action must be commenced within two years after the date on which the buyer closed the
120. purchase or transfer of the real property.

121. **SELLER'S REPRESENTATIONS:** The following are representations made by Seller to the extent of Seller's actual
122. knowledge.

123. (a) Radon test(s) HAVE HAVE NOT occurred on the property.
------(Check one.)-----

124. (b) Describe any known radon concentrations, mitigation, or remediation. **NOTE: Seller shall attach the most**
125. **current records and reports pertaining to radon concentration within the dwelling:**

126. _____

127. _____

128. _____

129. (c) There IS IS NOT a radon mitigation system currently installed on the property.
------(Check one.)-----

130. If "IS," Seller shall disclose, if known, information regarding the radon mitigation system, including system
131. description and documentation.

132. _____

133. _____

134. _____

135. **G. NOTICE REGARDING AIRPORT ZONING REGULATIONS:** The property may be in or near an airport safety zone
136. with zoning regulations adopted by the governing body that may affect the property. Such zoning regulations are
137. filed with the county recorder in each county where the zoned area is located. If you would like to determine if such
138. zoning regulations affect the property, you should contact the county recorder where the zoned area is located.

140. Property located at 800 N Arn Dr Mound MN 55364
141. **H. NOTICE REGARDING CARBON MONOXIDE DETECTORS:**
142. MN Statute 299F.51 requires Carbon Monoxide Detectors to be located within ten (10) feet from all sleeping
143. rooms. Carbon Monoxide Detectors may or may not be personal property and may or may not be included in the
144. sale of the home.
145. **I. WATER INTRUSION AND MOLD GROWTH:** Studies have shown that various forms of water intrusion affect many
146. homes. Water intrusion may occur from exterior moisture entering the home and/or interior moisture leaving the
147. home.
148. Examples of exterior moisture sources may be
149. • improper flashing around windows and doors,
150. • improper grading,
151. • flooding,
152. • roof leaks.
153. Examples of interior moisture sources may be
154. • plumbing leaks,
155. • condensation (caused by indoor humidity that is too high or surfaces that are too cold),
156. • overflow from tubs, sinks, or toilets,
157. • firewood stored indoors,
158. • humidifier use,
159. • inadequate venting of kitchen and bath humidity,
160. • improper venting of clothes dryer exhaust outdoors (including electrical dryers),
161. • line-drying laundry indoors,
162. • houseplants—watering them can generate large amounts of moisture.
163. In addition to the possible structural damage water intrusion may do to the property, water intrusion may also result
164. in the growth of mold, mildew, and other fungi. Mold growth may also cause structural damage to the property.
165. Therefore, it is very important to detect and remediate water intrusion problems.
166. Fungi are present everywhere in our environment, both indoors and outdoors. Many molds are beneficial to humans.
167. However, molds have the ability to produce mycotoxins that may have a potential to cause serious health problems,
168. particularly in some immunocompromised individuals and people who have asthma or allergies to mold.
169. To complicate matters, mold growth is often difficult to detect, as it frequently grows within the wall structure. If you
170. have a concern about water intrusion or the resulting mold/mildew/fungi growth, you may want to consider having
171. the property inspected for moisture problems before entering into a purchase agreement or as a condition of your
172. purchase agreement. Such an analysis is particularly advisable if you observe staining or any musty odors on the
173. property.
174. **J. NOTICE REGARDING PREDATORY OFFENDER INFORMATION:** Information regarding the predatory
175. offender registry and persons registered with the predatory offender registry under MN Statute 243.166
176. may be obtained by contacting the local law enforcement offices in the community where the property is
177. located or the Minnesota Department of Corrections at (651) 361-7200, or from the Department of Corrections
178. web site at www.corr.state.mn.us.

180. Property located at 800 N Arm Dr Mound MN 55364

181. **K. SELLER'S STATEMENT:**

182. *(To be signed at time of listing.)*

183. Seller(s) hereby authorizes any licensee(s) representing or assisting any party(ies) in this transaction to provide
184. a copy of this Disclosure Statement to any person or entity in connection with any actual or anticipated sale of the
185. property. A seller may provide this Disclosure Statement to a real estate licensee representing or assisting a
186. prospective buyer. The Disclosure Statement provided to the real estate licensee representing or assisting a
187. prospective buyer is considered to have been provided to the prospective buyer. If this Disclosure Statement is
188. provided to the real estate licensee representing or assisting the prospective buyer, the real estate licensee must
189. provide a copy to the prospective buyer.

190. **QUALIFIED THIRD-PARTY INSPECTION:** If Seller has made a disclosure under the Qualified Third-Party
191. Inspection, Seller is obligated to disclose to Buyer in writing of any new or changed facts of which Seller is aware
192. that could adversely and significantly affect the Buyer's use or enjoyment of the property or any intended use of
193. the property that occur up to the time of closing. To disclose new or changed facts, please use the *Amendment to*
194. *Disclosure Statement* form.

195. **WAIVER:** If Seller and Buyer agree to waive the seller disclosure requirement, Seller is NOT obligated to disclose
196. and will NOT disclose any new or changed information regarding facts.

197. **OTHER REQUIRED DISCLOSURES (Sections A-F):** Whether Seller has elected a Qualified-Third Party Inspection
198. or Waiver, Seller is obligated to notify Buyer, in writing, of any new or changed facts regarding Other Required
199. Disclosures up to the time of closing. To disclose new or changed facts, please use the *Amendment to Seller's*
200. *Disclosure* form.

201. James Franzel June 26, 2018
(Seller) (Date) (Seller) (Date)

202. **L. BUYER'S ACKNOWLEDGEMENT:**

203. *(To be signed at time of purchase agreement.)*

204. I/We, the Buyer(s) of the property, acknowledge receipt of this *Seller's Disclosure Alternatives* form and agree to
205. the seller's disclosure option selected in this form. I/We further agree that no representations regarding facts have
206. been made, other than those made in this form. This Disclosure Statement is not a warranty or a guarantee of
207. any kind by Seller or licensee representing or assisting any party in the transaction and is not a suitable substitute
208. for any inspections or warranties the party(ies) may wish to obtain.

209. The information disclosed is given to the best of the Seller's knowledge.

210. _____
(Buyer) (Date) (Buyer) (Date)

211. **LISTING BROKER AND LICENSEES MAKE NO REPRESENTATIONS HERE AND ARE**
212. **NOT RESPONSIBLE FOR ANY CONDITIONS EXISTING ON THE PROPERTY.**

Radon in Real Estate Transactions

All Minnesota homes can have dangerous levels of radon gas. Radon is a colorless, odorless and tasteless radioactive gas that can seep into homes from the soil. When inhaled, it can damage the lungs. Long-term exposure to radon can lead to lung cancer. About 21,000 lung cancer deaths each year in the United States are caused by radon.

The only way to know how much radon gas has entered the home is to conduct a radon test. MDH estimates 2 in 5 homes exceed the 4.0 pCi/L action level. Whether a home is old or new, any home can have high levels of radon.

The purpose of this publication is to educate and inform potential home buyers of the risks of radon exposure, and how to test for and reduce radon as part of real estate transactions.

Disclosure Requirements



Effective January 1, 2014, the Minnesota Radon Awareness Act requires specific disclosure and education be provided to potential home buyers during residential real estate transactions in Minnesota. **Before signing a purchase agreement to sell or transfer residential real property**, the seller shall provide this publication and shall disclose in writing to the buyer:

1. whether a radon test or tests have occurred on the property;
2. the most current records and reports pertaining to radon concentrations within the dwelling;
3. a description of any radon levels, mitigation, or remediation;
4. information on the radon mitigation system, if a system was installed; and
5. a radon warning statement.

MDH Minnesota
Department of Health

INDOOR AIR UNIT

Radon Facts

How dangerous is radon? Radon is the number one cause of lung cancer in non-smokers, and the second leading cause overall. Your risk for lung cancer increases with higher levels of radon, prolonged exposure, and whether or not you are a current smoker or former smoker.

Where is your greatest exposure to radon? For most Minnesotans, your greatest exposure is at home where radon can concentrate indoors.

What is the recommended action based on my results? If the average radon in the home is at or above 4.0 pCi/L, the home's radon level should be reduced. Also, consider mitigating if radon levels are between 2.0 pCi/L and 3.9 pCi/L. Any amount of radon, even below the recommended action level, carries some risk.



MDH Radon Program
PO Box 64975
St Paul, MN 55164-0975
health.indoor@state.mn.us
www.health.state.mn.us/radon
651-201-4601
800-798-9050



Instanet

Radon Testing

Any test lasting less than three months requires **closed-house conditions**. Keep all windows and doors closed, except for normal entry and exit.

Before testing: Begin closed-house conditions at least 12 hours before the start of the radon test.

During testing: Maintain closed-house conditions during the entire duration of the short-term test. Operate home heating or cooling systems normally during the test. Test for at least 48 hours.

Where should the test be conducted? Any radon test conducted for a real estate transaction needs to be placed in the lowest livable area of the home suitable for occupancy. This is typically in the basement, whether finished or unfinished.

Place the test kit:

- twenty inches to six feet above the floor
- at least three feet from exterior walls
- four inches away from other objects
- in a location where it won't be disturbed
- not in enclosed areas or areas of high heat or humidity

Radon Mitigation

When elevated levels of radon are found, they can be easily reduced by a certified radon mitigation professional.

Radon mitigation is the process used to reduce radon concentrations in buildings. This is done by drawing soil gas from under the house and venting it above the roof. A quality mitigation system should reduce levels to below 4.0 pCi/L, if not lower.

After a radon mitigation system is installed perform an independent short-term test to ensure the reduction system is effective. Operate the radon system during the entire test. This test will confirm low levels in the home. Be sure to retest the house every two years to confirm continued radon reduction.

Radon Warning Statement

"The Minnesota Department of Health strongly recommends that ALL homebuyers have an indoor radon test performed prior to purchase or taking occupancy, and recommends having the radon levels mitigated if elevated radon concentrations are found. Elevated radon concentrations can easily be reduced by a qualified, certified, or licensed, if applicable, radon mitigator.

Every buyer of any interest in residential real property is notified that the property may present exposure to dangerous levels of indoor radon gas that may place the occupants at risk of developing radon-induced lung cancer. Radon, a Class A human carcinogen, is the leading cause of lung cancer in nonsmokers and the second leading cause overall. The seller of any interest in residential real property is required to provide the buyer with any information on radon test results of the dwelling".

How are radon tests conducted in real estate transactions? There are special protocols for radon testing. The two most common ways to test are either using a calibrated continuous radon monitor (CRM) or two-short term test kits used at the same time. The short-term test kits are placed 4 inches apart and the results are averaged.

Continuous Radon Monitor (CRM)

Fastest



Simultaneous Short-term Testing

Second Fastest



All radon tests should be conducted by a certified professional. This ensures the test was conducted properly, in the correct location, and under appropriate building conditions. A list of these radon measurement professionals can be found at MDH's Radon website. If the seller previously conducted testing in a property at or above 4 pCi/L, the home should be mitigated.

DISCLOSURE STATEMENT: WELL

This form approved by the Minnesota Association of REALTORS®, which disclaims any liability arising out of use or misuse of this form. © 2017 Minnesota Association of REALTORS®, Edina, MN

1. Date 05/17/2018
2. Page 1 of _____ pages: THE REQUIRED MAP
3. IS ATTACHED HERE AND MADE A PART OF THIS
4. DISCLOSURE

5. Minnesota Statute 1031.235 requires that, before signing an agreement to sell or transfer real property, Seller must disclose information in writing to Buyer about the status and location of all known wells on the property. This requirement is satisfied by delivering to Buyer either a statement by Seller that Seller does not know of any wells on the property, or a disclosure statement indicating the legal description and county, and a map showing the location of each well. In the disclosure statement Seller must indicate, for each well, whether the well is in use, not in use or sealed.
- 6.
- 7.
- 8.
- 9.
10. Unless Buyer and Seller agree to the contrary in writing, before the closing of the sale, a Seller who fails to disclose the existence or known status of a well at the time of sale, and knew or had reason to know of the existence or known status of the well, is liable to Buyer for costs relating to sealing of the well and reasonable attorneys' fees for collection of costs from Seller, if the action is commenced within six years after the date Buyer closed the purchase of the real property where the well is located.
- 11.
- 12.
- 13.
- 14.
15. Legal requirements exist relating to various aspects of location and status of wells. Buyer is advised to contact the local unit(s) of government, state agency, or qualified professional which regulates wells for further information about these issues. For additional information on wells, please visit the Minnesota Department of Health's website at www.health.state.mn.us.
- 16.
- 17.
- 18.

19. **Instructions for completion of this form are on page three (3).**

20. **PROPERTY DESCRIPTION:** Street Address: 800 N Arm Dr

21. Mound 55364 Hennepin
(City) (Zip) (County)

22. **LEGAL DESCRIPTION:**
23. **LOT 009 AUDITOR 'S SUBD. NO. 362 LOT 9 AUD SUBD NO 362 AND OUTLOT 1**
24. **PIRATES COVE**

25. **WELL DISCLOSURE STATEMENT: (Check appropriate boxes.)**

26. Seller certifies that the following wells are located on the above-described real property.

	MN Unique Well No.	Well Depth	Year of Const.	Well Type	IN USE	NOT IN USE	SHARED	SEALED
29. Well 1	<u>—</u>	<u>?</u>	<u>?</u>	<u>?</u>	<input checked="" type="checkbox"/>	<input type="checkbox"/>	<input type="checkbox"/>	<input type="checkbox"/>
30. Well 2	<u>—</u>	<u>—</u>	<u>—</u>	<u>—</u>	<input type="checkbox"/>	<input type="checkbox"/>	<input type="checkbox"/>	<input type="checkbox"/>
31. Well 3	<u>—</u>	<u>—</u>	<u>—</u>	<u>—</u>	<input type="checkbox"/>	<input type="checkbox"/>	<input type="checkbox"/>	<input type="checkbox"/>

32. Is this property served by a well not located on the property? Yes No

33. If "Yes," please explain: _____

35. **NOTE: See definition of terms "IN USE," "NOT IN USE," and "SEALED" on lines 102-113. If a well is not in use, it must be sealed by a licensed well contractor or a well owner must obtain a maintenance permit from the Minnesota Department of Health and pay an annual maintenance fee. Maintenance permits are not transferable. If a well is operable and properly maintained, a maintenance permit is not required.**

39. If the well is, "Shared":
40. (1) How many properties or residences does the shared well serve? _____

41. (2) Who manages the shared well? _____

42. (3) Is there a maintenance agreement for the shared well? Yes No

43. If "Yes," what is the annual maintenance fee? \$ _____

45. Property located at 800 N Arm Dr Mound MN 55364

46. **OTHER WELL INFORMATION:**

47. Date well water last tested for contaminants: unknown Test results attached? Yes No

48. Contaminated Well: Is there a well on the property containing contaminated water? Yes No

49. Comments: not that I am aware of

50. _____
51. _____
52. _____
53. _____
54. _____
55. _____

56. **SEALED WELL INFORMATION:** For each well designated as sealed above, complete this section.

57. When was the well sealed? _____

58. Who sealed the well? _____

59. Was a Sealed Well Report filed with the Minnesota Department of Health? Yes No

60. **MAP:** Complete the attached *Location Map* showing the location of each well on the real property.

61. This disclosure is not a warranty of any kind by Seller(s) or any licensee(s) representing or assisting any part(ies) in
62. this transaction and is not a substitute for any inspections or warranties the party(ies) may wish to obtain.

63. **SELLER'S STATEMENT:** *(To be signed at time of listing.)*

64. Seller(s) hereby states that the facts as stated above are true and accurate and authorizes any licensee(s) representing
65. or assisting any party(ies) in this transaction to provide a copy of this Disclosure Statement to any person or entity
66. in connection with any actual or anticipated sale of the property. A seller may provide this Disclosure Statement to
67. a real estate licensee representing or assisting a prospective buyer. The Disclosure Statement provided to the real
68. estate licensee representing or assisting a prospective buyer is considered to have been provided to the prospective
69. buyer. If this Disclosure Statement is provided to the real estate licensee representing or assisting the prospective
70. buyer, the real estate licensee must provide a copy to the prospective buyer.

71. **Seller is obligated to continue to notify Buyer in writing of any facts that differ from the facts disclosed here**
72. **(new or changed) of which Seller is aware that could adversely and significantly affect the Buyer's use or**
73. **enjoyment of the property or any intended use of the property that occur up to the time of closing.** To disclose
74. new or changed facts, please use the *Amendment to Disclosure Statement* form.

75. Janice Franzel June 26, 2018
(Seller) (Date) (Seller) (Date)

76. **BUYER'S ACKNOWLEDGEMENT:** *(To be signed at time of purchase agreement.)*

77. I/We, the Buyer(s) of the property, acknowledge receipt of this *Disclosure Statement: Well and Location Map* and
78. agree that no representations regarding facts have been made other than those made above.

79. _____
(Buyer) (Date) (Buyer) (Date)

80. **LISTING BROKER AND LICENSEES MAKE NO REPRESENTATIONS HERE AND ARE**
81. **NOT RESPONSIBLE FOR ANY CONDITIONS EXISTING ON THE PROPERTY.**

82.

INSTRUCTIONS FOR COMPLETING THE WELL DISCLOSURE STATEMENT

83. **DEFINITION:** A "well" means an excavation that is drilled, cored, bored, washed, driven, dug, jetted, or otherwise
84. constructed if the excavation is intended for the location, diversion, artificial recharge, or acquisition of groundwater.

85. **MINNESOTA UNIQUE WELL NUMBER:** All new wells constructed AFTER January 1, 1975, should have been
86. assigned a Minnesota unique well number by the person constructing the well. If the well was constructed after this
87. date, you should have the unique well number in your property records. If you are unable to locate your unique well
88. number and the well was constructed AFTER January 1, 1975, contact your well contractor. If no unique well number
89. is available, please indicate the depth and year of construction for each well.

90. **WELL TYPE:** Use one of the following terms to describe the well type.

91. **WATERWELL:** A water well is any type of well used to extract groundwater for private or public use. Examples
92. of water wells are: domestic wells, drive-point wells, dug wells, remedial wells, and municipal wells.

93. **IRRIGATION WELL:** An irrigation well is a well used to irrigate agricultural lands. These are typically
94. large-diameter wells connected to a large pressure distribution system.

95. **MONITORING WELL:** A monitoring well is a well used to monitor groundwater contamination. The well is
96. typically used to access groundwater for the extraction of samples.

97. **DEWATERING WELL:** A dewatering well is a well used to lower groundwater levels to allow for construction
98. or use of underground spaces.

99. **INDUSTRIAL/COMMERCIAL WELL:** An industrial/commercial well is a nonpotable well used to extract
100. groundwater for any nonpotable use, including groundwater thermal exchange wells (heat pumps and heat
101. loops).

102. **WELL USE STATUS:** Indicate the use status of each well. CHECK ONLY ONE (1) BOX PER WELL.

103. **IN USE:** A well is "in use" if the well is operated on a daily, regular, or seasonal basis. A well in use includes
104. a well that operates for the purpose of irrigation, fire protection, or emergency pumping.

105. **NOT IN USE:** A well is "not in use" if the well does not meet the definition of "in use" above and has not been
106. sealed by a licensed well contractor.

107. **SEALED:** A well is "sealed" if a licensed contractor has completely filled a well by pumping grout material
108. throughout the entire bore hole after removal of any obstructions from the well. A well is "capped" if it has
109. a metal or plastic cap or cover which is threaded, bolted or welded into the top of the well to prevent entry
110. into the well. A "capped" well is not a "sealed" well.

111. If the well has been sealed by someone other than a licensed well contractor or a licensed well sealing
112. contractor, check the well status as "not in use."

113. If you have any questions, please contact the Minnesota Department of Health, Well Management Section,
114. at (651) 201-4587 (metropolitan Minneapolis–St. Paul) or 1-800-383-9808 (greater Minnesota).

MN-DS:W-3 (8/17)

LOCATION MAP

This form approved by the Minnesota Association of REALTORS®, which disclaims any liability arising out of use or misuse of this form. © 2009 Minnesota Association of REALTORS®, Edina, MN

1. Page _____ of _____ pages
2. Please use the space below to sketch the real property being sold and, to Seller's knowledge, the approximate location of any of the following on the property.
- 3.
4. SUBSURFACE SEWAGE TREATMENT SYSTEM WELL METHAMPHETAMINE PRODUCTION AREA
(Check all that apply.)
5. Include approximate distances from fixed reference points such as streets, buildings and landmarks.
6. Property located at 800 N Arm Dr
7. Mound, MN 55364

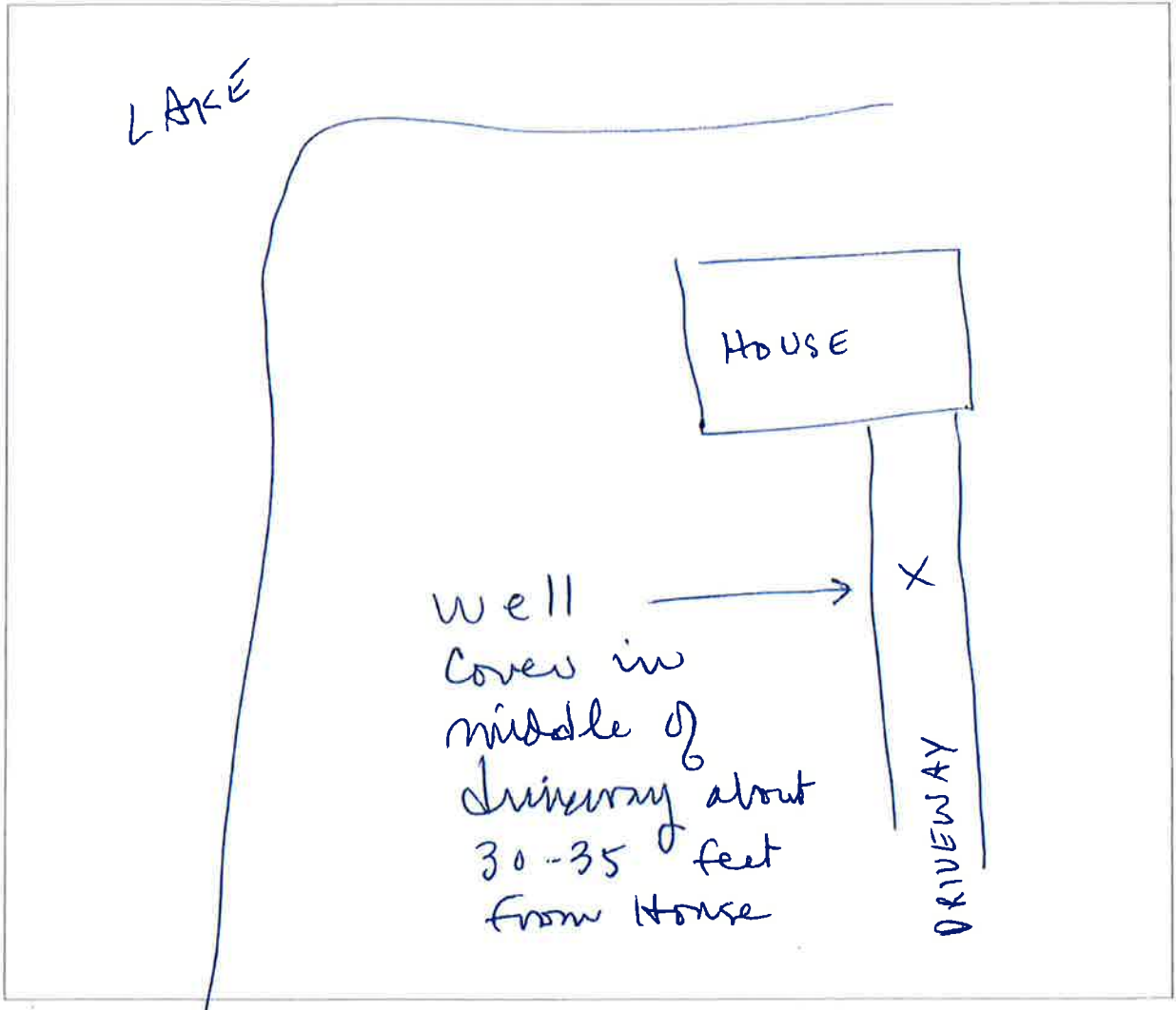

8. ATTACH ADDITIONAL SHEETS AS NEEDED.
9. Seller and Buyer initial: JF June 26, 2018
(Seller) (Date) (Buyer) (Date)
10. _____
(Seller) (Date) (Buyer) (Date)

11. ORIGINAL COPY TO LISTING BROKER; COPIES TO SELLER, BUYER, SELLING BROKER
MN-IM (8/09)